

Budget King Post
 26x42'6"
 Bents I and IV
 Preliminary drawing
 10/10/2022

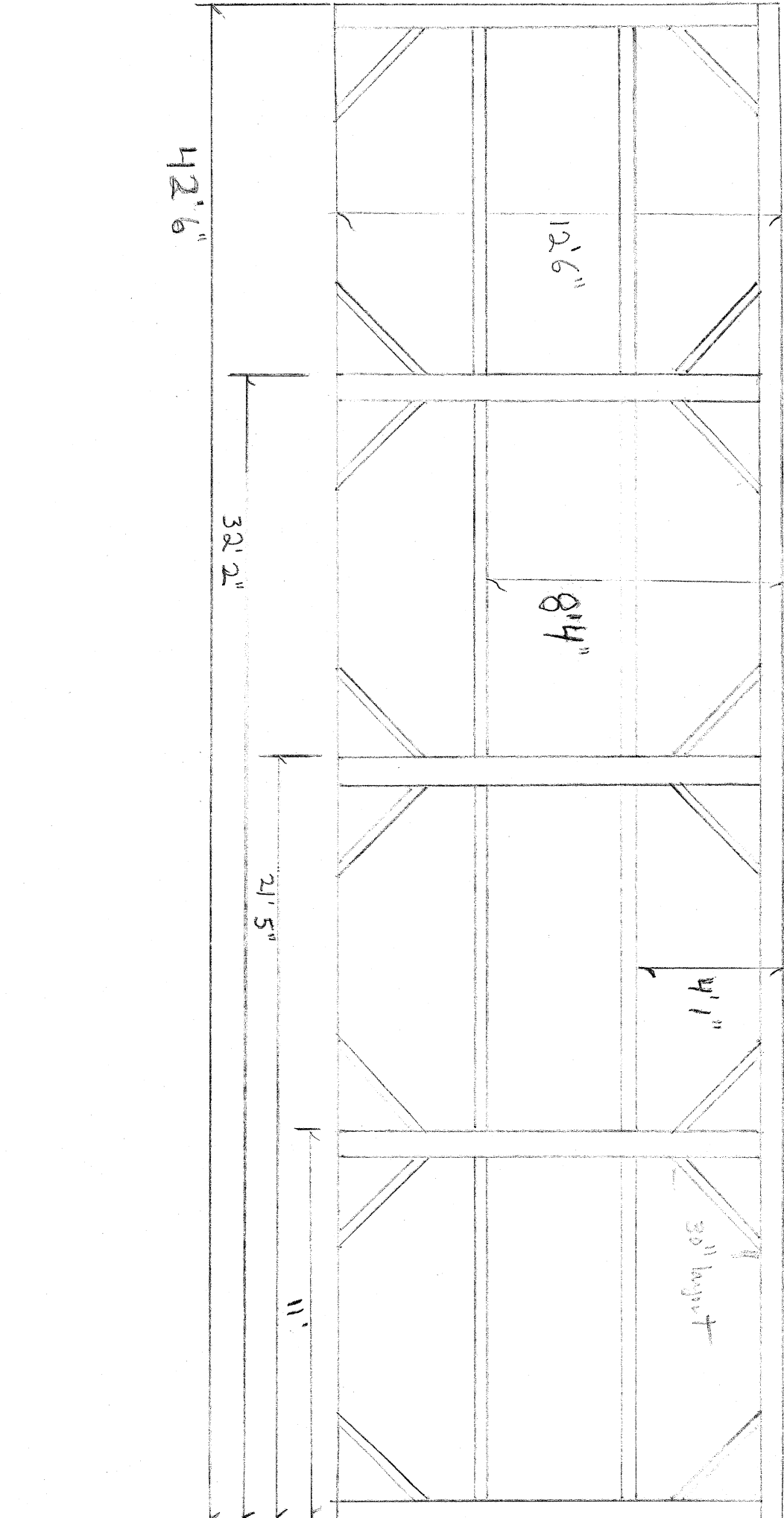

B V

B IV

B III

B II

B I

42' 6"

32' 2"

21' 5"

11'

12' 6"

8' 4"

4' 1"

30" height

Bridge King Post
 2 1/2 x 4 1/2 x 6"
 Plate wall
 Retaining drawing
 10/10/22
 1/4" scale

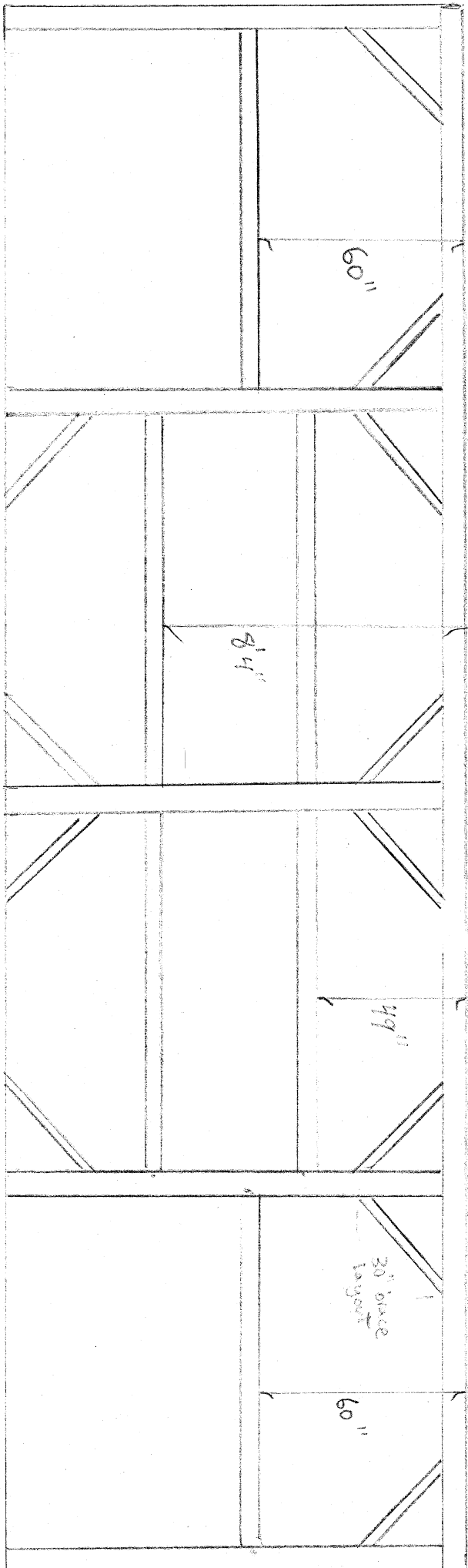

XBV

XBIV

XBIII

XBII

XBI

60"

8'4"

49"

30" brace layout

60"

Bridge King Est
 26x42.6"
 X plate wall
 Preliminary Drawing
 10/19/2012
 1/4" scale

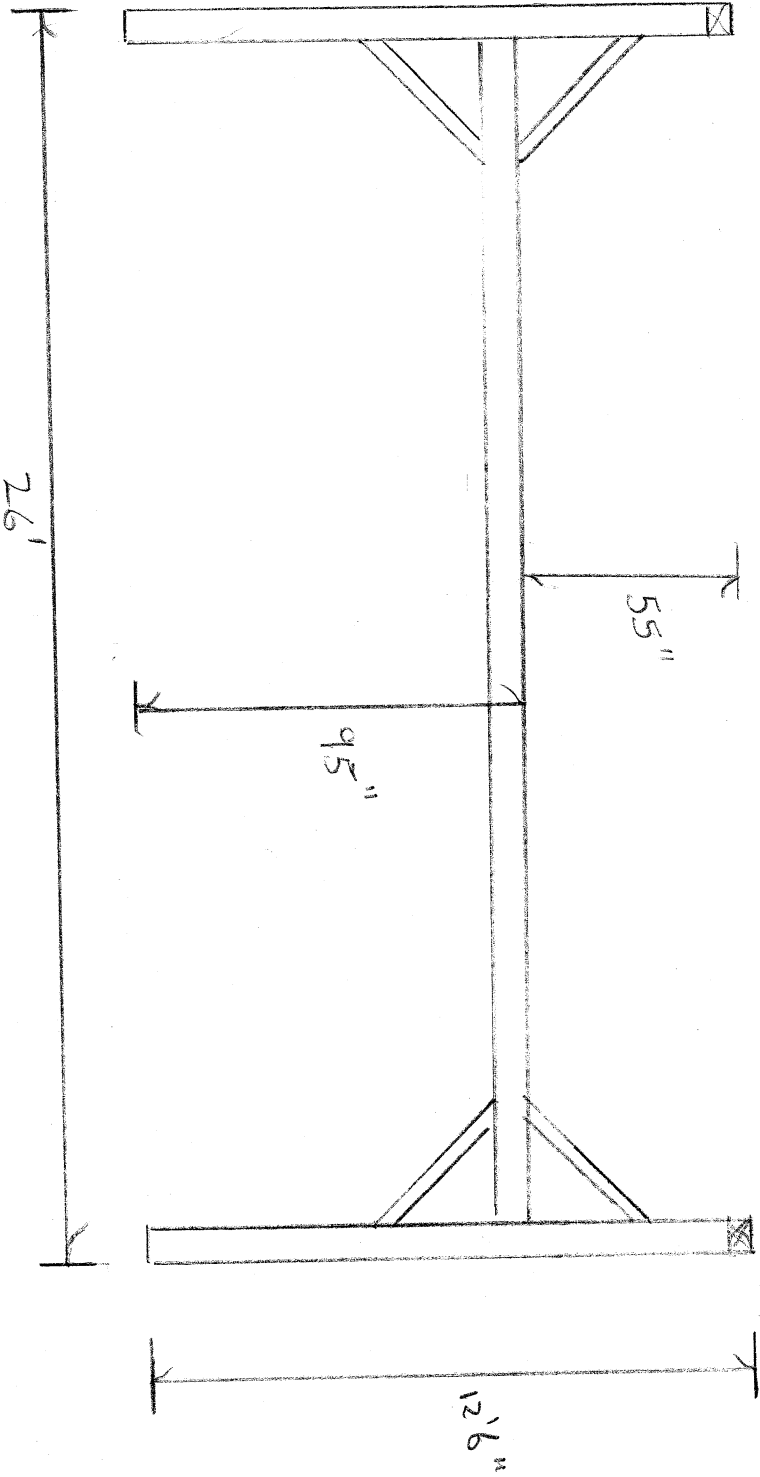

Bridge King Post
 26x92'6"
 Bents II and IV
 Preliminary drawing
 10/10/2022

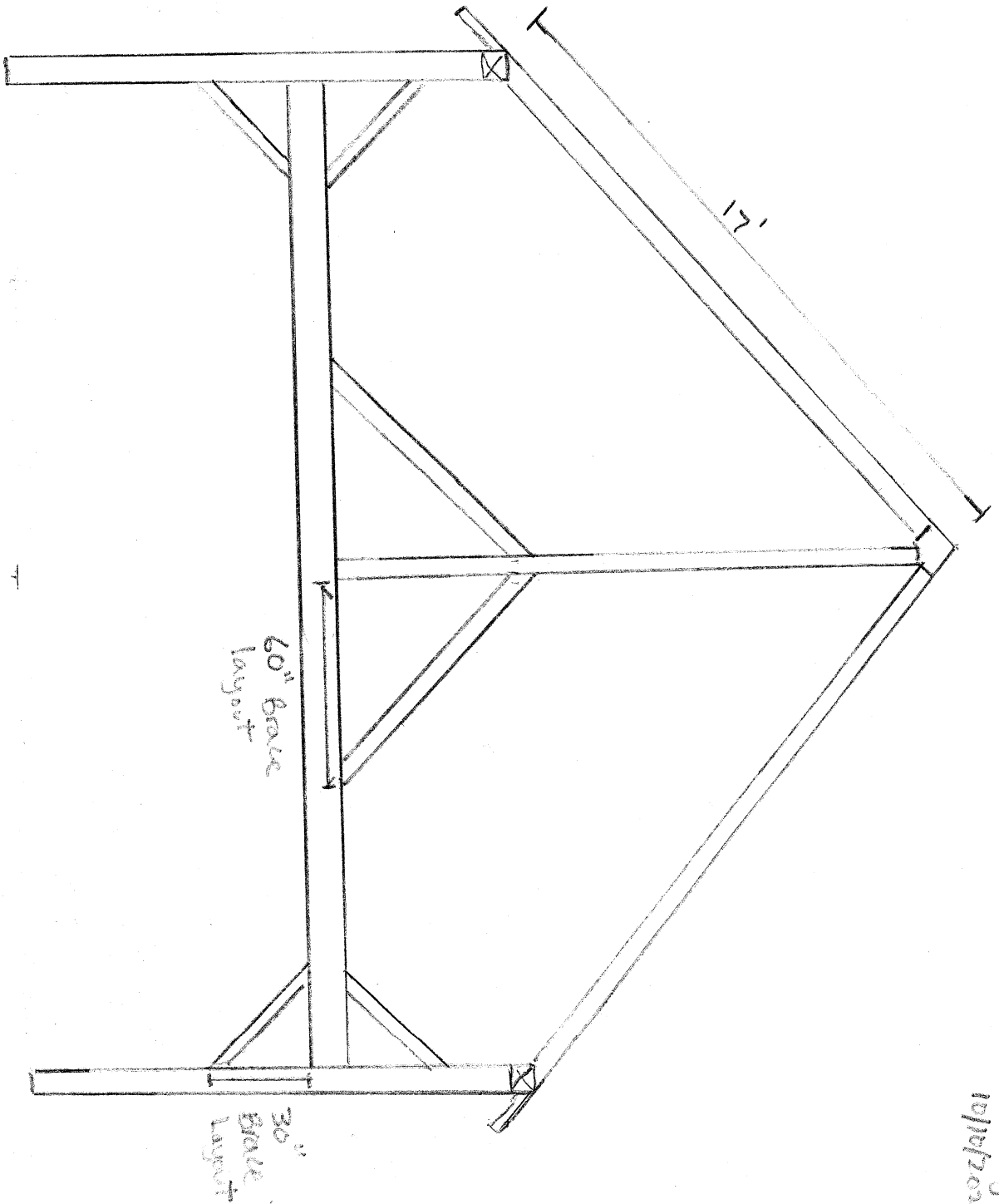

Bridport 160g Post
26x42' 6"
Beet III
Preliminary Drawing
10/16/2022